

MATERIAL

» 2.0060 (E-Cu 57)

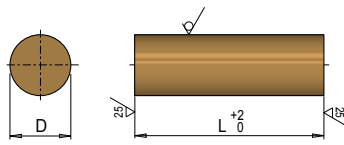

D	L	Nr.	EUR	D	L	Nr.	EUR
4	505	V 91411/ 4/505	<>	45	505	V 91411/ 45/505	<>
5	505	V 91411/ 5/505	<>	50	122	V 91411/ 50/122	<>
6	505	V 91411/ 6/505	<>	50	250	V 91411/ 50/250	<>
7	505	V 91411/ 7/505	<>	50	505	V 91411/ 50/505	<>
8	505	V 91411/ 8/505	<>	60	122	V 91411/ 60/122	<>
9	505	V 91411/ 9/505	<>	60	250	V 91411/ 60/250	<>
10	505	V 91411/ 10/505	<>	60	505	V 91411/ 60/505	<>
12	505	V 91411/ 12/505	<>	70	122	V 91411/ 70/122	<>
14	505	V 91411/ 14/505	<>	70	250	V 91411/ 70/250	<>
15	505	V 91411/ 15/505	<>	70	505	V 91411/ 70/505	<>
16	505	V 91411/ 16/505	<>	80	122	V 91411/ 80/122	<>
18	505	V 91411/ 18/505	<>	80	250	V 91411/ 80/250	<>
20	505	V 91411/ 20/505	<>	80	505	V 91411/ 80/505	<>
25	505	V 91411/ 25/505	<>	90	122	V 91411/ 90/122	<>
30	505	V 91411/ 30/505	<>	90	250	V 91411/ 90/250	<>
35	250	V 91411/ 35/250	<>	90	505	V 91411/ 90/505	<>
35	505	V 91411/ 35/505	<>	100	122	V 91411/100/122	<>
40	250	V 91411/ 40/250	<>	100	250	V 91411/100/250	<>
40	505	V 91411/ 40/505	<>	100	505	V 91411/100/505	<>
45	250	V 91411/ 45/250	<>				